

# TECHNICAL DATASHEET

Reference: RAK16002-87\*

Product: SWING single lever bath and shower mixer



\*RAK16002-87

Chrome Finish



\*RAK16002-87.GD1

Gold Color  
Glossy Finish

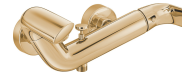

\*RAK16002-87.RG1

Rose Gold Color  
Glossy Finish



\*RAK16002-87.BK1

Black Color  
Glossy Finish

## Product Description:

single lever bath and shower mixer DN 15  
solid lever  
wall fastening  
ceramic cartridge with hot water safety device  
aerator M24 x 1  
flow class 8 ltr/min#  
automatic diverter: shower to bath tub  
shower outlet G 1/2 inch  
protected against backflow  
S-unions 1/2 inch x 3/4 inch  
without shower set, noise level I  
in accordance to EN 817  
with flow regulator 8 ltr/min#

## Advertisement:

- \* KLUDI RAK LLC SWING single lever bath and shower mixer item no. RAK16002-87
- \* ceramic cartridge with hot water safety device  $\varnothing$  35 mm, DIN EN 817
- \* Chrome plated/PVD Gold/PVD Rose Gold/PVD Black brass, DIN 50930-6

single lever bath and shower mixer, manufacturer KLUDI RAK LLC, KLUDI RAK SWING single lever bath and shower mixer item no. RAK16002-87, DN 15, Chrome plated/PVD Gold/PVD Rose Gold/PVD Black brass, S-unions 1/2 inch x 3/4 inch, aerator M24 x 1, flow regulator 8 ltr/min, solid lever, noise level DIN EN 4109 group I, without report no., type: single lever bath and shower mixer DN 15, automatic diverter: shower to bath tub, protected against backflow, DIN EN 1717, shower outlet 1/2 inch, lever projection 88 mm, ceramic cartridge with hot water safety device  $\varnothing$  35 mm, nozzle projection 196 mm, projection 215 mm, breadth 325 mm, diameter rosette 70 mm, for pressure type water heater, for continuous line heater, PN 10

## Line Drawing:

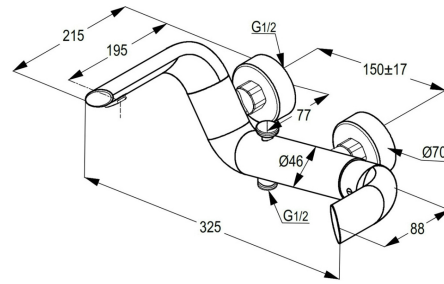

## Water Flow Rate#:

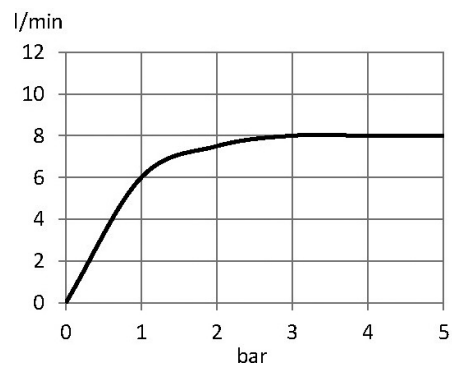

# variation:  $\pm$  15%



RAK16002-87 online

1/6/2021

**KLUDI**  
**RAK**

"We Stand for Water Saving"